

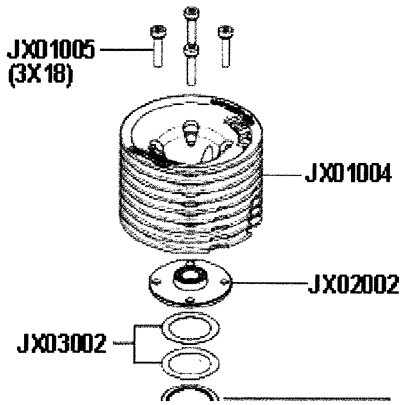

JX21-B02

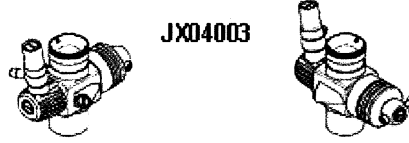

Displacement : 3.49cc / Bore : 16.27mm / Stroke : 16.80mm / Practical R.P.M. : 4,000~40,000r.p.m.
Power Output : 2.55ps/33,000r.p.m. / Weight : 361g / Ports : 3h / Sleeve : ABC
Crankshaft Diam. : 14mm / Glow Plug Type : Conical / Carburetor Diam. 7mm (Variable) /
Carburetor Adjustment : Double



JX04003

JX05013.60